

# DC8016BCD *Power Adjustable Size 1~6*

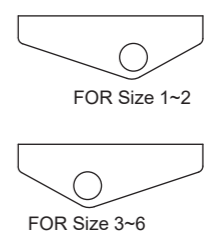

⊕ FACTORY PRE-SET

Size	Number of turns	Direction	Max. opening angle
1	0	Counterclockwise	180°
2	0~+2	Counterclockwise	180°
⊕3	2~+4	Clockwise	180°
4	+3~+6	Clockwise	180°
5	+6~+9	Clockwise	180°
6	+9~+12	Clockwise	180°

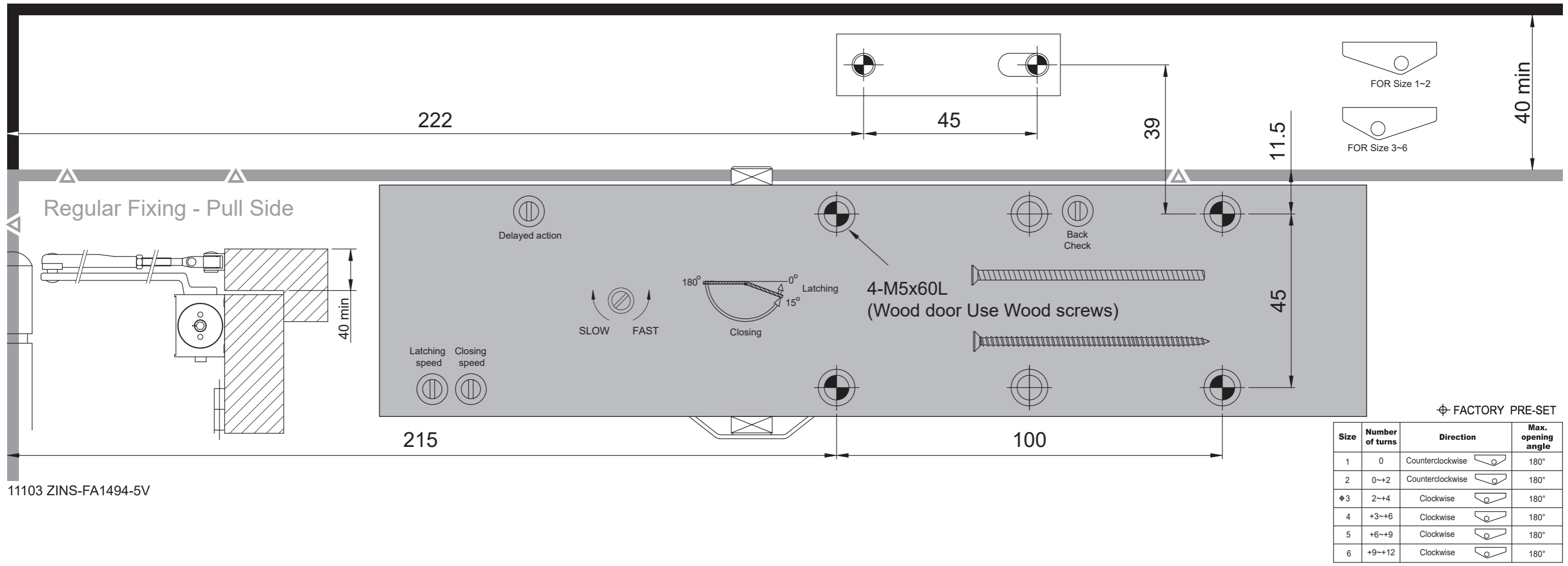
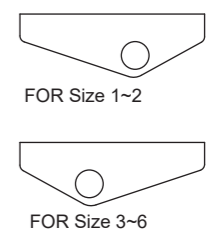
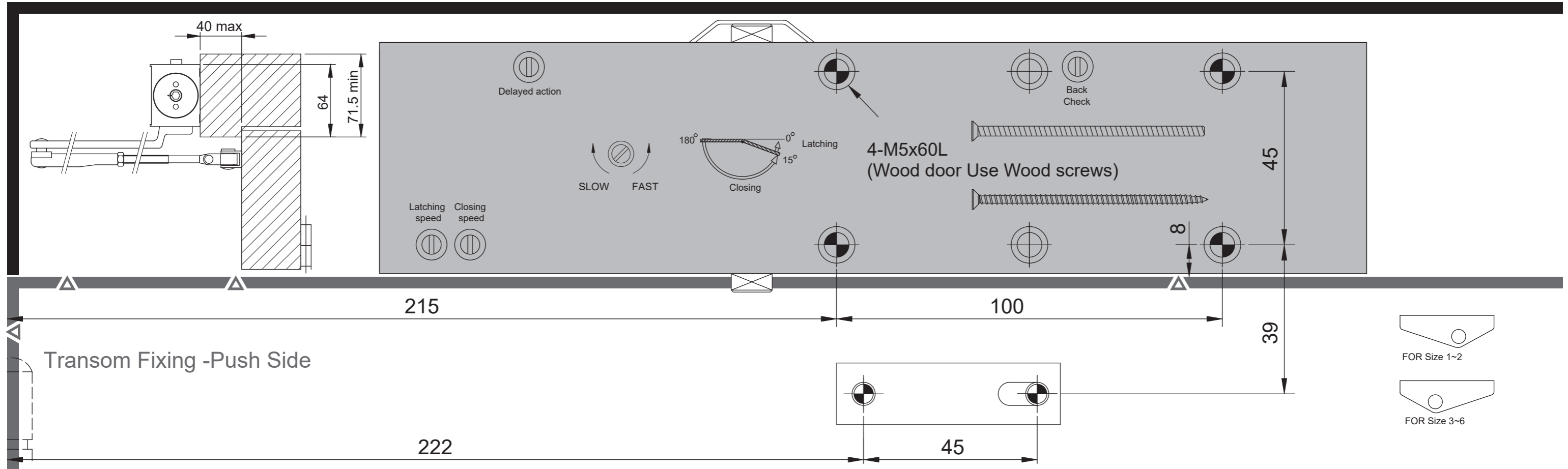

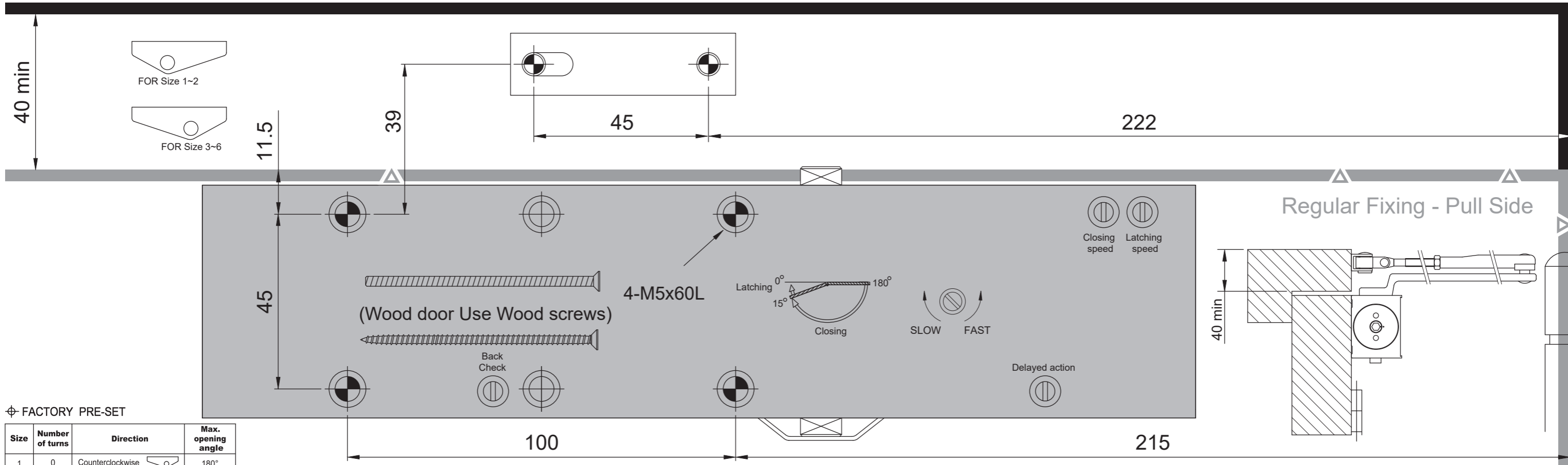

⊕ FACTORY PRE-SET

Size	Number of turns	Direction	Max. opening angle
1	0	Counterclockwise	180°
2	0~+2	Counterclockwise	180°
⊕3	2~+4	Clockwise	180°
4	+3~+6	Clockwise	180°
5	+6~+9	Clockwise	180°
6	+9~+12	Clockwise	180°

